

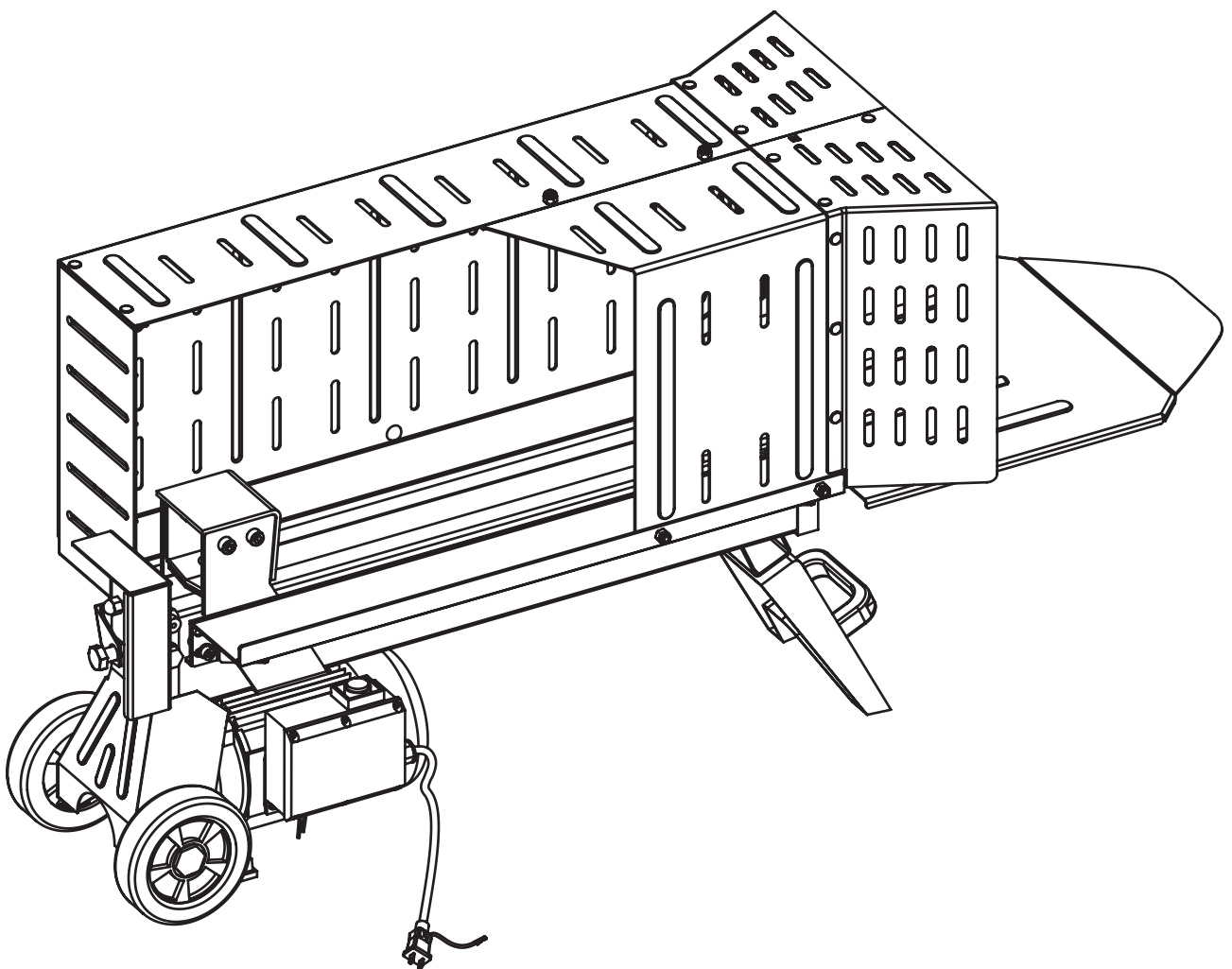

SLS7HE

***7T Electric 2.3kw (520mm)  
Hydraulic Log Splitter***







CE

# **FOR YOUR SAFETY**

**READ AND UNDERSTAND THE ENTIRE MANUAL  
BEFORE OPERATING MACHINE**

**Save This Manual for Future Reference**

## SAFETY WARNINGS & CAUTIONS

SAFETY WARNINGS & INSTRUCTIONS	SYMBOL AFFIXED TO THE MACHINE
<ul style="list-style-type: none"><li>● <b>UNDERSTAND YOUR LOG SPLITTER</b> Read and understand the owner's manual and labels affixed to the log splitter. Learn its application and limitations as well as any specific potential hazards specific to it.</li><li>● <b>DRUGS, ALCOHOL AND MEDICATION</b> Do not operate the log splitter while under the influence of drugs, alcohol or any medication that could affect your ability to use it properly.</li><li>● <b>AVOID DANGEROUS CONDITIONS</b> Put the log splitter on a 60 - 75cm high, stable, flat and level work bench where there is plenty of room for handling and help the operator stay alert. Bolt the log splitter to the work surface if it tends to slip, walk or slide. Keep your work area clean and well lit. Cluttered areas increase the risk of injury. Do not use the log splitter in wet or damp areas or expose it to rain. Do not use it in areas where fumes from paint, solvents or flammable liquids pose a potential hazard.</li></ul>	
<ul style="list-style-type: none"><li>● <b>INSPECT YOUR LOG SPLITTER</b> Check your log splitter before turning it on. Keep guards in place and in working order. Form a habit of checking to see that keys and adjusting wrenches are removed from tool area before turning it on. Replace damaged, missing or failed parts before using it.</li></ul>	
<ul style="list-style-type: none"><li>● <b>DRESS PROPERLY</b> Do not wear loose clothing, gloves, neckties or jewellery (rings, wrist watches). They can be caught in moving parts. Protective electrically non conductive gloves and non-skid footwear are recommended when working. Wear protective hair covering to contain long hair, preventing it from getting caught in machinery.</li></ul>	
<ul style="list-style-type: none"><li>● <b>PROTECT YOUR EYES AND FACE</b> Any log splitter may throw foreign objects into the eyes. This can cause permanent eye damage. Always wear safety goggles. Everyday eyeglasses have only impact resistant lenses. They are not safety glasses. Do not put the log splitter on the ground for operations. This brings the operator's face closer to the machine and increases the risk of being struck by wood, chips or debris.</li></ul>	

### ● EXTENSION CORDS

Improper use of extension cords may cause inefficient operation of the log splitter which can result in overheating. Be sure the extension cord is no longer than 10m and its section is no less than 2.5mm<sup>2</sup>, to allow sufficient current flow to the motor.

Avoid use of free and inadequately insulated connections. Connections must be made with protected material suitable for outdoor use.

### ● AVOID ELECTRICAL SHOCK

Check that the electric circuit is adequately protected and that it corresponds with the power, voltage and frequency of the motor. Check that there is a ground connection and a regulation differential switch upstream.

Ground the log splitter. Prevent body contact with grounded surfaces: pipes, radiators, ranges and refrigerator enclosures.

Never open the pushbutton box on the motor. Should this be necessary, contact a qualified electrician.

Make sure your fingers do not touch the plug's metal prongs when plugging or unplugging the log splitter.

### ● KEEP VISITORS AND CHILDREN AWAY

The log splitter must be always operated by one person only. Other people should keep a safe distance from the work area, especially when the log splitter is under operation. Never use another person to help you with freeing jammed log.

### ● INSPECT YOUR LOG

Make sure there are no nails or foreign objects in logs to be split. The ends of the logs must be cut square. Branches must be cut off flush with the trunk.

### ● DON'T OVER REACH

Floor must not be slippery.

Keep proper footing and balance at all times.

Never stand on the log splitter. Serious injury could occur if the tool is tipped or if the cutting tool is unintentionally contacted. Do not store anything above or near the log splitter where anyone might stand on the tool to reach them.

### ● AVOID INJURY FROM UNEXPECTED ACCIDENT

Always pay full attention to the movement of the log pusher.

Do not attempt to load the log on until the log pusher has stopped.

Keep hands out of the way of all moving parts.

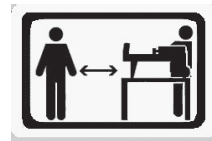

● **PROTECT YOUR HANDS**

Keep your hands away from splits and cracks which open in the log. They may close suddenly and crush or amputate your hands. Do not remove jammed logs with your hands.



● **DON'T FORCE TOOL**

Never try to split logs larger than those indicated in the specifications table. This could be dangerous and may damage the machine.

Don't use the log splitter for a purpose for which it was not intended.

● **NEVER LEAVE TOOL RUNNING UNATTENDED**

Don't leave the tool until it has come to a complete stop.

● **DISCONNECT POWER**

Unplug when not in use, before making adjustments, changing parts, cleaning or working on the log splitter. Consult technical manual before servicing.

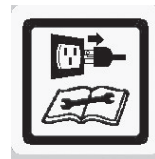

● **PROTECT THE ENVIRONMENT**

Take used oil to an authorized collection point or follow the stipulations in the country where the log splitter is used.

Do not discharge into drains, soil or water.



● **MAINTAIN YOUR LOG SPLITTER WITH CARE**

Keep the log splitter clean for best and safest performance.

● **MAKE THE WORKSHOP CHILDPROOF**

Lock the shop. Disconnect master switches. Store the log splitter away from children and others not qualified to use it.

## TABLE OF CONTENTS

Safety Warnings & Cautions .....	2
Application Conditions.....	5
Specifications .....	5
Electrical Requirements .....	5
Set up and Preparation for Operation .....	6
Assembly Instruction .....	8
Wiring Diagram .....	10
Plumbing Diagram .....	10
Log Splitter Operation .....	11
Freeing a Jammed Log .....	12
Replacing Hydraulic Oil .....	13
Sharpening Wedge .....	14
Trouble Shooting .....	14

## APPLICATION CONDITIONS

This log splitter is a home use model. It is designed for operating under ambient temperatures between +5°C and 40°C and for installation at altitudes no more than 1000m above M.S.L. The surrounding humidity should be less than 50% at 40°C. It can be stored or transported under ambient temperatures between -25°C and 55°C.

## SPECIFICATIONS

<b>Model Number</b>	SLS7HE		
<b>Motor</b>	230V~	50Hz	2300W IP54
<b>Log Capacity</b>	<b>Diameter</b>	5 ~ 25cm	
	<b>Length</b>	52cm	
<b>Splitting Force</b>	7T		
<b>Hydraulic Pressure</b>	28Mpa		
<b>Net Weight</b>	56.5 kg		

The diameter of the log is indicative – a small log can be difficult to split when it has knobs or a particularly tough fiber. On the other hand, it may not be difficult to split logs with regular fibers even if its diameter exceeds the max. figure indicated above.

## ELECTRICAL REQUIREMENTS

Connect the main leads to a standard 230V±10% (50Hz±1Hz) electrical supply which has protection devices of under-voltage, over-voltage, over-current as well as a residual current device (RCD) with maximum residual current rated at 0.03A.

# SET UP AND PREPARATION FOR OPERATION

1. Bolt the frontal support stand to the log splitter, lift the log splitter by the handles at both ends and place it on a 60 – 75cm high, stable, flat and level work surface.
2. Familiarize yourself with the controls and features of this log splitter in the illustrations.

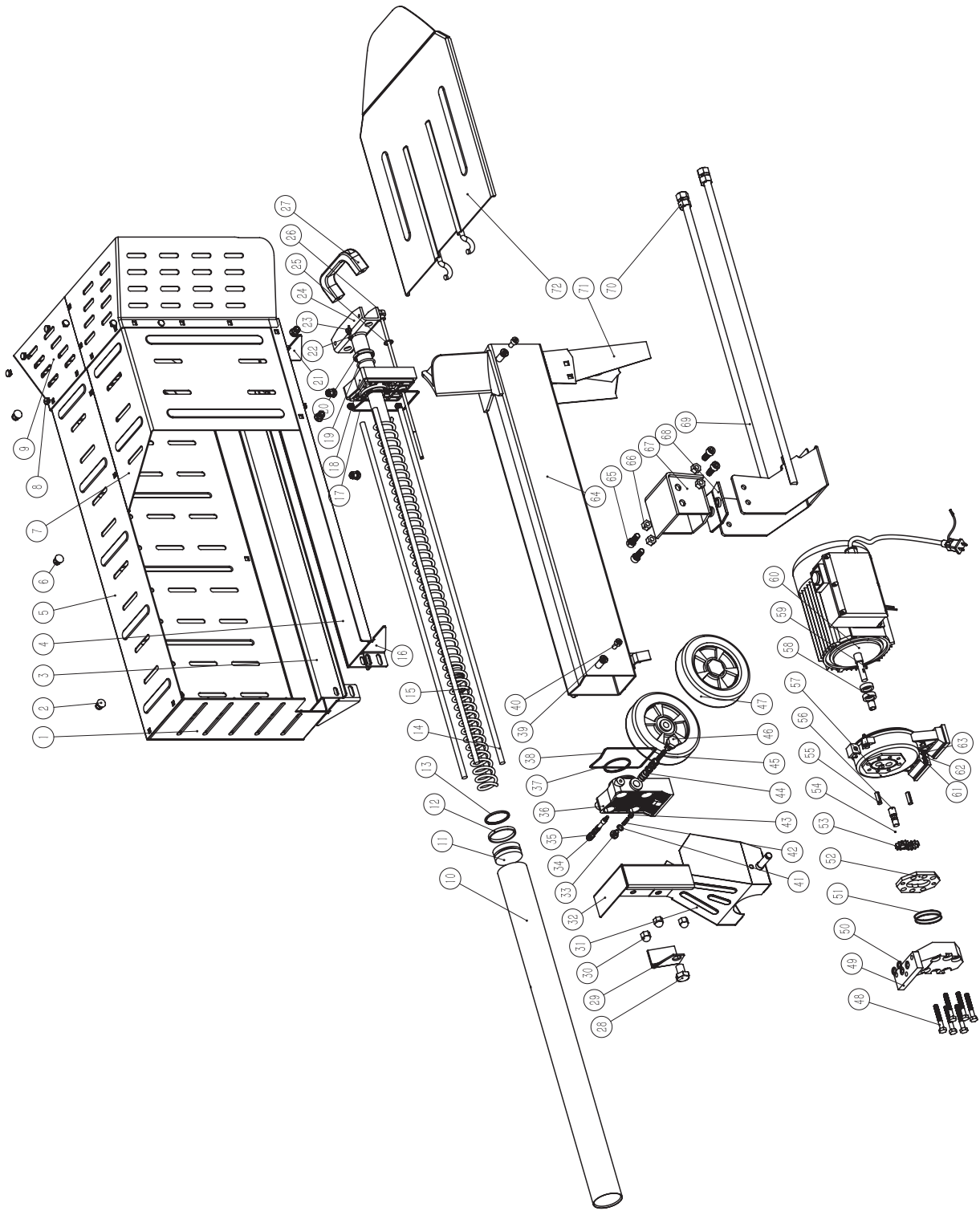

No.	Name	Qty
1	Back cover	1
2	Bolt M8×16	7
3	Right support plate	1
4	Left support plate	1
5	Right cover	1
6	Nut M8	7
7	Left cover	1
8	Nylon fixed	16
9	Protection guard	1
10	Cylinder	1
11	Piston	1
12	ST type ring 55	1
13	Gasket ring 23.6×3.55	1
14	Two-head bolt	4
15	Big spring	1
16	Reinforcing rib left	2
17	Mouth mat	1
18	Cylinder aluminum cover	1
19	Gasket ring 30×3.55	1
20	CK-type ring	1
21	Reinforcing rib right	2
22	Gasket ring 5.3×1.8	1
23	Bleed screw M6	1
24	Piston rod	1
25	Washer 14	1
26	Bolt M14×1.5	1
28	Fixing nut for operation handle	1
29	Operation handle	1
30	Nut M10	3
31	Back steel-plate support	1
32	Handle guard	1
33	Screw M8×8	1
34	Small Spring (I)	1
35	Small spindle	1
36	Aluminum block	1
37	Gasket ring 55×3.1	1

No.	Name	Qty
38	Mouth mat	1
39	Gasket 8	4
40	Bolt M8×16	4
41	Gasket8	1
42	Small Spring	1
43	Bolt M8×8	1
44	Inner sheath	1
45	Small Spring (II)	1
46	Bolt M16×1.5	1
47	Wheel	2
48	Bolt M8X50	6
49	Gear pump housing	1
50	Gasket ring 10×2.65	2
51	Gasket ring	2
52	Division plate	1
53	Gear	2
54	Ball φ2.5	1
55	Pin	2
56	Shaft sleeve	2
57	Motor front cover	1
58	Oil seal	2
59	Pin	1
60	Motor	1
61	Outer hexagon bolt M5×25	3
62	Spring washer 5	3
63	Flat washer 5	3
64	Workable tank	1
65	Inner hexagon bolt M10×20	4
66	Nut M10	4
67	Movable plate	1
68	Plastic pad	1
69	Support bracket	1
70	Nut M14	4
71	Frontal support stand	1
72	Stock supporting plate	1

## Assembly Instruction

1. Insert the left cover (7) into the groove of the left support plate (4), Ensure that the square hole on the left cover (7) is aligned with the square hole of the left support plate (4). Use 2 x bolt M8x16 (2) and 2 x nut M8 (6) to tighten the left cover (7) and the left support plate (4). As shown in Figure 1a and 2a.

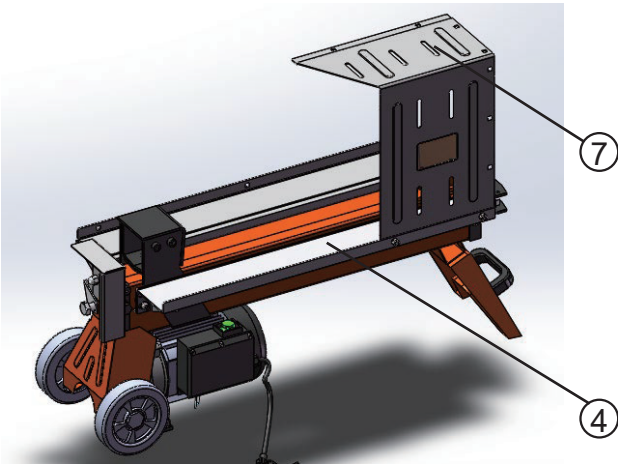

Figure 1a

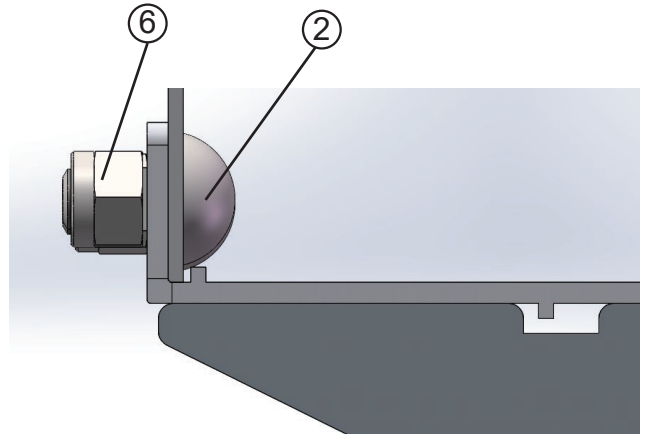

Figure 2a

2. Insert the right cover (5) into the groove of the right support plate (3), ensure hole alignment. Then use 3 x bolt M8 (2) and 3 x nut M8 (6) for tightening. After the tightening is completed, use 2 x Bolt M8 (2) and 2 x nut M8 (6) and tighten the left and right covers respectively. As shown in Figures 2a, 2b, 2c.

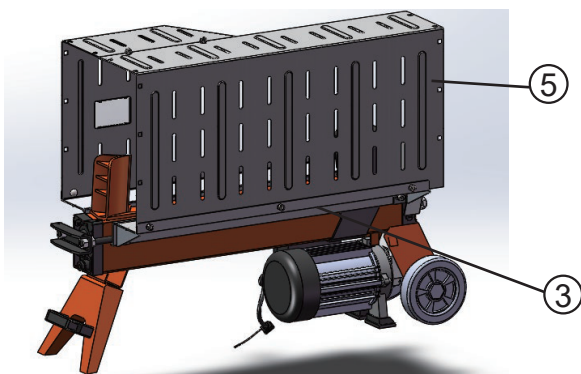

Figure 2a

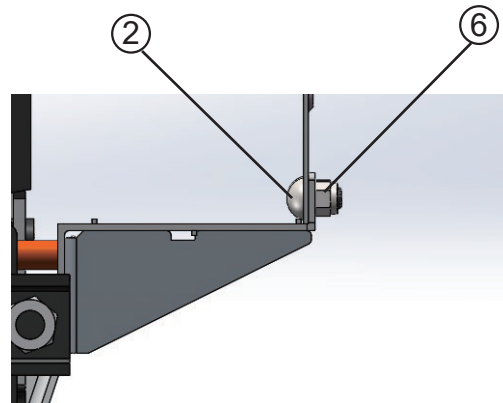

Figure 2b

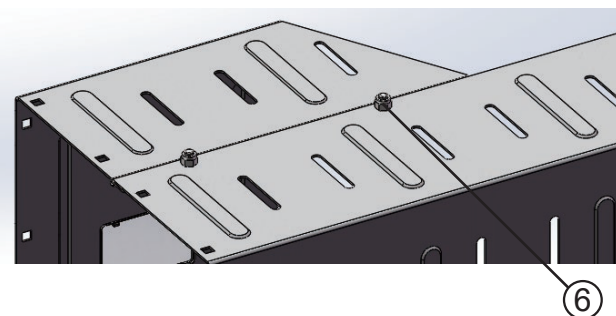

Figure 2c

- Hook the frontal support stand (71) to the circular convex platform, as shown in Figure 3a.

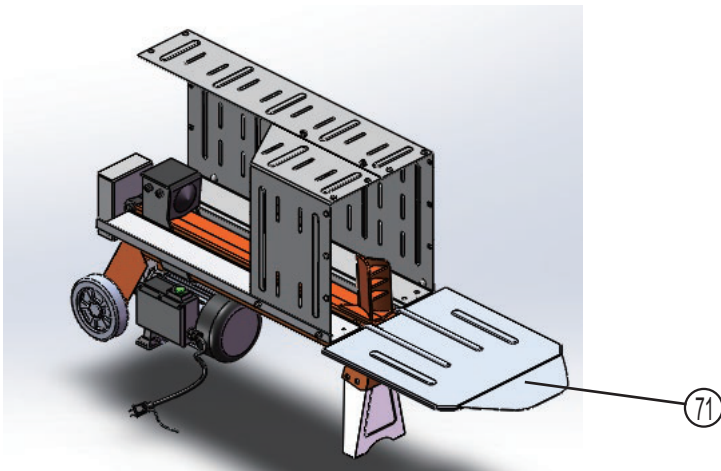

Figure 3a

- Keep the square holes of the protection guard (9) aligned with the square holes on the left and right covers, then use 11 x nylon fixed connectors (8) to fasten them. After completion, using the same method to keep the square hole on the right cover aligned with the square hole of the back cover (1) and fasten with 5 x nylon fixed connectors (8), as shown in Figure 4a.



Figure 4a

Before operating the log splitter, the bleed screw should be loosened slightly until air can go in and out of the oil tank smoothly.

Air flow through the bleed screw hole should be detectable while the log splitter is under operation.

Before moving the log splitter, make sure the bleed screw is tightened to avoid oil leaking from this point.



**FAILURE TO LOOSEN THE BLEED SCREW WILL KEEP THE SEALED AIR IN THE HYDRAULIC SYSTEM BEING COMPRESSED AFTER BEING DECOMPRESSED. SUCH CONTINUOUS AIR COMPRESSION AND DECOMPRESSION WILL BLOW OUT THE SEALS OF THE HYDRAULIC SYSTEM AND CAUSE PERMANT DAMAGE TO THE LOG SPLITTER.**



**DO NOT ADJUST THE MAX PRESSURE LIMITING SCREW!**

*Max pressure was set during production of the log splitter and the max pressure limiting screw is sealed with glue, to ensure the log splitter works under pressure no more than 7 tons. The setting was done by a qualified technician with professional instruments.*

*Unauthorized resetting will cause the hydraulic pump to fail to output enough splitting pressure and COULD RESULT IN SERIOUS INJURY, AS WELL AS DAMAGE TO THE MACHINE .*

## WIRING DIAGRAM

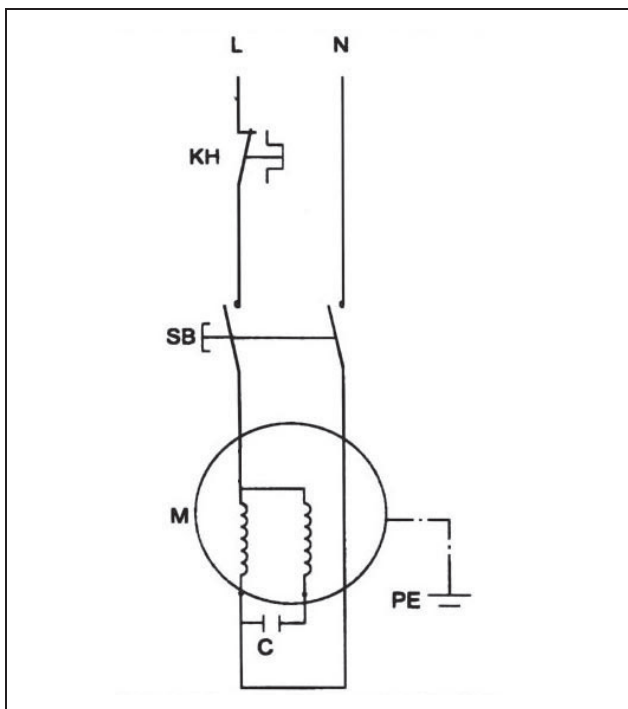

## PLUMBING DIAGRAM

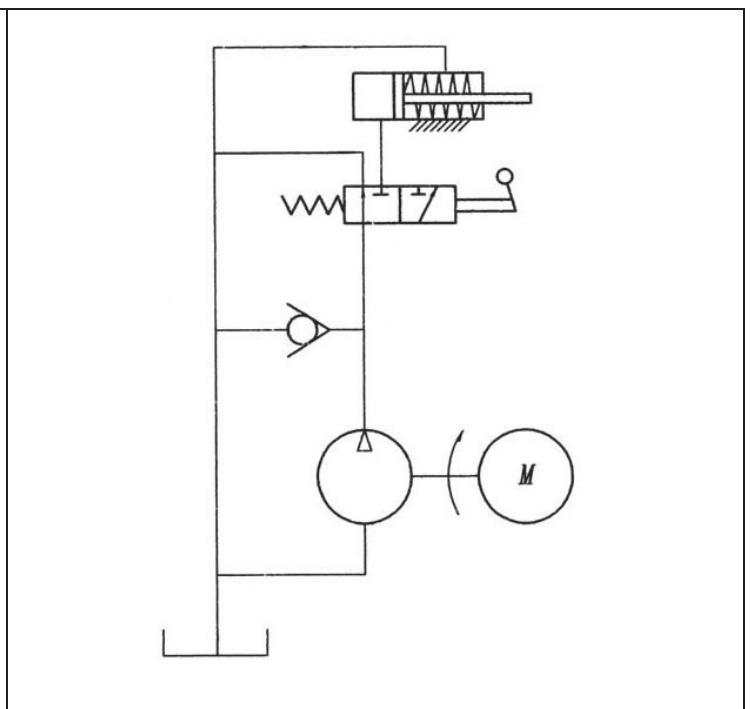

## LOG SPLITTER OPERATION

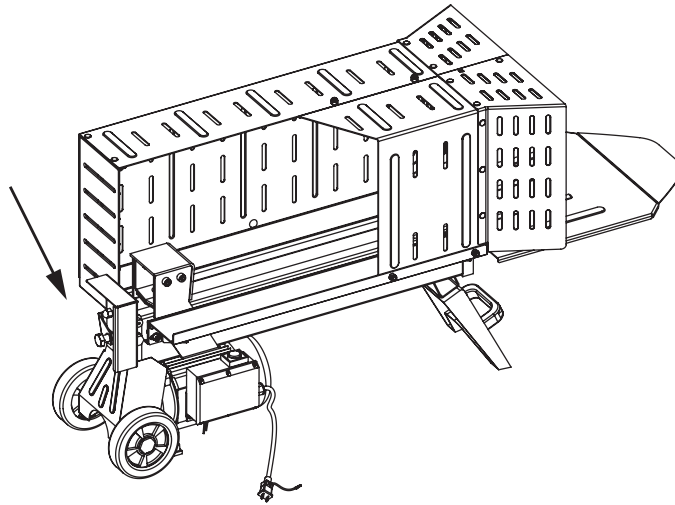

This log splitter is equipped with a “ZHB” control system that requires to be operated by both hands of the user – The left hand controls the hydraulic control lever while the right hand controls the pushbutton switch. The log splitter will cease operating upon absence of either hand. Only after both hands release the controls, the log pusher starts to return backward to the starting position.

Before the job, the splitter should be placed on the platform 850mm above the ground, as shown in the figure below.

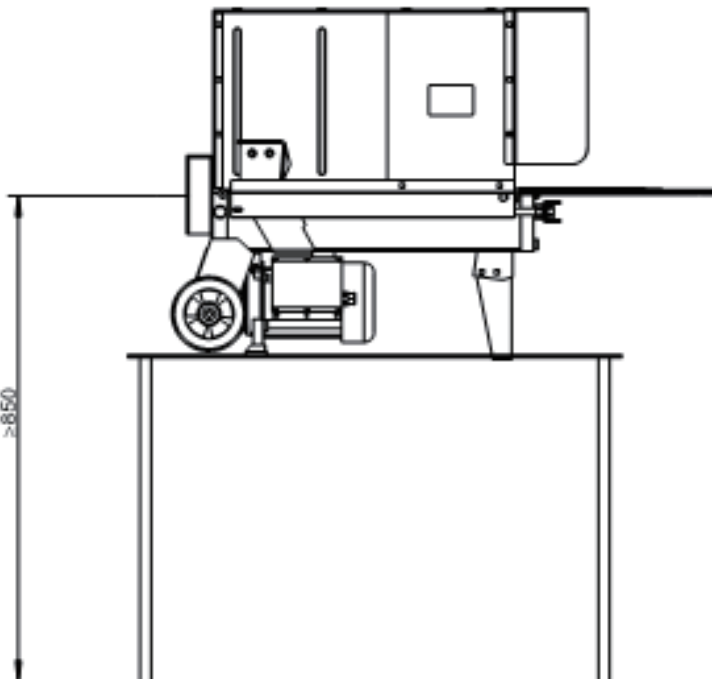

A trigger type lock-out device is adopted to avoid accidental Hydraulic Control Lever pushdown. To operate the Hydraulic Control Lever, draw the Trigger backward with the index finger before pushing the Hydraulic Control Lever forward.

- ⊘ **Never force the log splitter for more than 5 seconds by keeping pressure on it to split excessively hard wood.**

After this time interval, the oil under pressure will be overheated and the machine could be damaged. For such extremely hard log, rotate it by 90° to see whether it can be split in a different direction. In any case, if you are not able to split the log, this means that its hardness exceeds the capacity of the machine and thus that log should be discarded to protect the log splitter.

**Always set logs firmly on the log retaining plates and work table. Make sure logs will not twist, rock or slip while being split. Do not force the blade by splitting the log on the upper part. This will break the blade or damage the machine.**

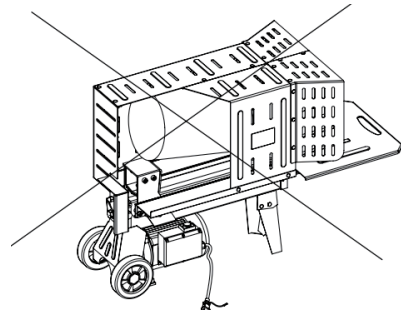

Break logs in the direction of its growing grain. Do not place logs across the log splitter for splitting. It may be dangerous and may seriously damage the machine. Do not attempt to split 2 pieces of logs at the same time. One of them may fly up and hit you.

## **FREEING A JAMMED LOG**

- Release both controls.
- After the log pusher moves back and completely stops at its starting position, insert a wedge wood under the jammed log.
- Start the log splitter to push the wedge wood to go completely under the jammed one.
- Repeat above procedure with sharper slope wedge woods until the log is completely freed.

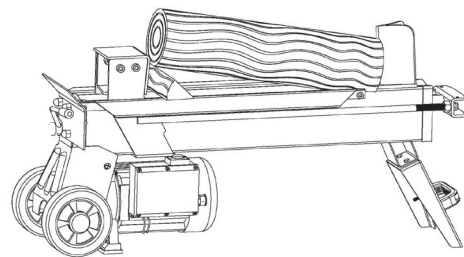

**Do not try to knock the jammed log off. This will damage the machine and may cause the log to eject from the machine, causing personal injury.**

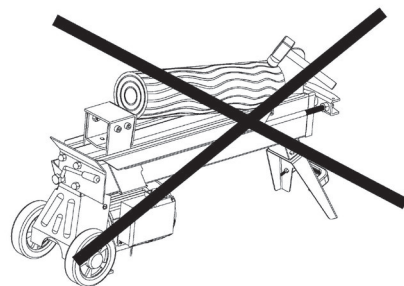

## REPLACING HYDRAULIC OIL

Replace the hydraulic oil in the log splitter after every 150 hours of use. Take the following steps to replace it.

- Make sure all moving parts have stopped and the log splitter is unplugged.
- Unscrew the oil drain bolt with dipstick to remove it.
- Lift the log splitter on the support leg over a 4 litre capacity container to drain and contain the hydraulic oil.
- Lift the log splitter on the motor side.
- Refill fresh hydraulic oil at the volume as per the hydraulic oil capacity of a particular model indicated in below specifications table.

HYDRAULIC OIL CAPACITY	HYDRAULIC OIL MODEL
3.2L	ISO VG 32 or ISO VG 46

- Clean the surface of the dipstick on the oil drain bolt and put it back into the oil tank while keeping the log splitter vertically.
- Make sure the level of the refilled oil is just between the 2 grooves around the dipstick.
- Clean the oil drain bolt before re-inserting them. Make sure they are tightened to avoid leakage before placing the log splitter horizontally.

**Periodically check oil level to ensure it is between the 2 grooves marked on the dipstick. When lower than the lowest groove, oil refilling is required.**

**The following hydraulic oils or equivalent are recommend for the log splitter's hydraulic transmission system:**

SHELL Tellus 22  
MOBIL DTE 11  
ARAL Vitam GF 22  
BP Energol HLP-HM 22

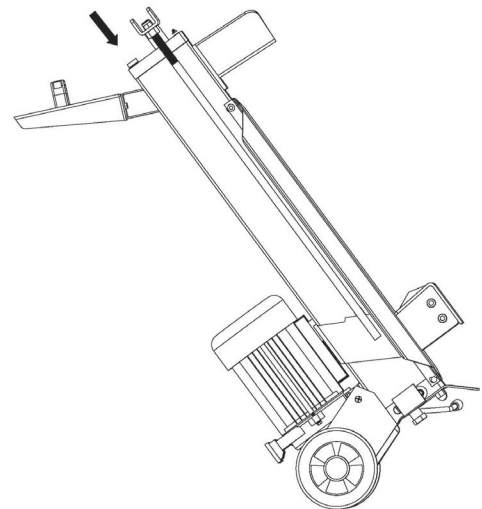
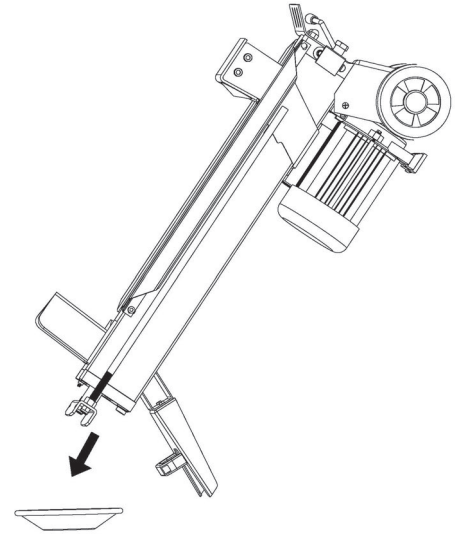

## SHARPENING WEDGE

After using the log splitters for some time, sharpen the wedge of the log splitter using a fine-toothed file and smooth any burrs or crushed areas along the cutting edge.

## TROUBLE SHOOTING

PROBLEM	PROBABLE CAUSE	REMEDY SUGGESTED
Motor fails to start	Overload protection device disengaged to protect the log splitter from being damaged	Contact a qualified Electrician for opening the Pushbutton Box to engage the Overload Protection Device inside.
Fails to split logs	Log is improperly positioned.	Refer to “ Log Splitter Operation ” section for perfect log loading.
	The sizes or hardness of the log exceeds the capacity of the machine.	Reduce the log sizes before splitting it on the log splitter.
	Wedge cutting edge is blunt.	Refer to “ Sharpening Wedge ” section to sharpen the cutting edge.
	Oil leaks.	Locate leak(s) and contact the dealer.
	Unauthorized adjustment was made on Max. Pressure Limiting Screw. Lower max pressure rating was set.	Contact the dealer.
The log pusher moves jerkily, taking unfamiliar noise or vibrating a lot	Lack of hydraulic oil and excessive air in the hydraulic system.	Check oil level for possible oil refilling. Contact the dealer.
Oil leaks around cylinder ram or from other points	Air sealed in hydraulic system while operating.	Loosen Bleed Screw by 3 ~ 4 rotations before operating the log splitter.
	Bleed Screw is not tightened before moving the log splitter.	Tighten the Bleed Screw up before moving the log splitter.
	Oil Drain Bolt with Dipstick is not tight.	Tighten the Oil Drain Bolt with Dipstick.
	Hydraulic Control Valve Assembly and / or seal (s) worn.	Contact the dealer.



Waste electrical products should not be disposed of with household waste, please recycle where facilities exist, check with your local authority or retailer for recycling advice.



SGS Engineering (UK) Ltd  
Unit 1, West Side Park  
Raynesway  
Derby, DE21 7AZ

## EC Declaration of Conformity

This is an important document and should be retained

MANUFACTURER'S NAME: SGS Engineering (UK) Ltd

TYPE OF EQUIPMENT: Log Splitter

PART NUMBER: SLS7HE

APPLICATION OF EC COUNCIL DIRECTIVES / STANDARD:

2006/42/EC Machinery Directive  
EN 609-1:2017  
EN 60204-1:2018

I, the undersigned, hereby declare that the equipment specified above conforms to the above European Communities Directive(s) and Standard(s).

PLACE: Derby, UK

DATE: 24th JUNE 2025

A handwritten signature in black ink, appearing to read 'Neil Sansom', written over a horizontal line.

(Signature)

Neil Sansom

Company Chief Executive

Officer





1 West Side Park, Belmore Way, Raynesway, Derby, DE21 7AZ